

BILL OF MATERIAL

REF.	PART NO.	DESCRIPTION	REF.	PART NO.	DESCRIPTION
1	5829	CLEVIS ASSY	16	6617	REPLACEMENT THROTTLE GRIP
2	3805	RUDDER CABLE STOP, REAR	17	1920	HL HANDLEBAR
3	3644	HT4 RUDDER CABLE	18	5523	55HP CARBURETED, THROTTLE CABLE FRONT
3	5640	HT6 RUDDER CABLE	18	5522	55HP CARBURETED, THROTTLE CABLE REAR
4	5703	STEERING CLAMP ASSY	18	5565	55HP OIL INJECTED, THROTTLE CABLE ASSY
5	2474	WASHER	18	5412	65HP CARBURETED, THROTTLE CABLE FRONT
6	3531	5-STAR CLAMPING KNOB	18	5411	65HP CARBURETED, THROTTLE CABLE REAR
7	3803	SXS CONTROLS, SLIDER ASSEMBLY	18	5571	65HP OIL INJECTED, THROTTLE CABLE ASSY
8	3804	RUDDER CABLE STOP, FORWARD	18	5224	65HP FUEL INJECTED, THROTTLE CABLE
9	3587	SHAFT COLLAR	18	5775	100HP FUEL INJECTED, THROTTLE CABLE
10	3925	HT STEERING COLUMN ASSY	18	5510	55/65HP, OIL INJECTOR CABLE
11	3728	END CAP	19	5531	55HP CARBURETED, CHOKE CABLE ASSY.
12	3492	REPLACEMENT PORT GRIP	19	5413	65HP CARBURETED, CHOKE CABLE ASSY.
13	3491	CLUTCH CONTROLLER	20	2659	CORRUGATED LOOM, GREY
14	6539	HT HANDLEBAR CLAMP			
15	3490	THROTTLE LEVER			

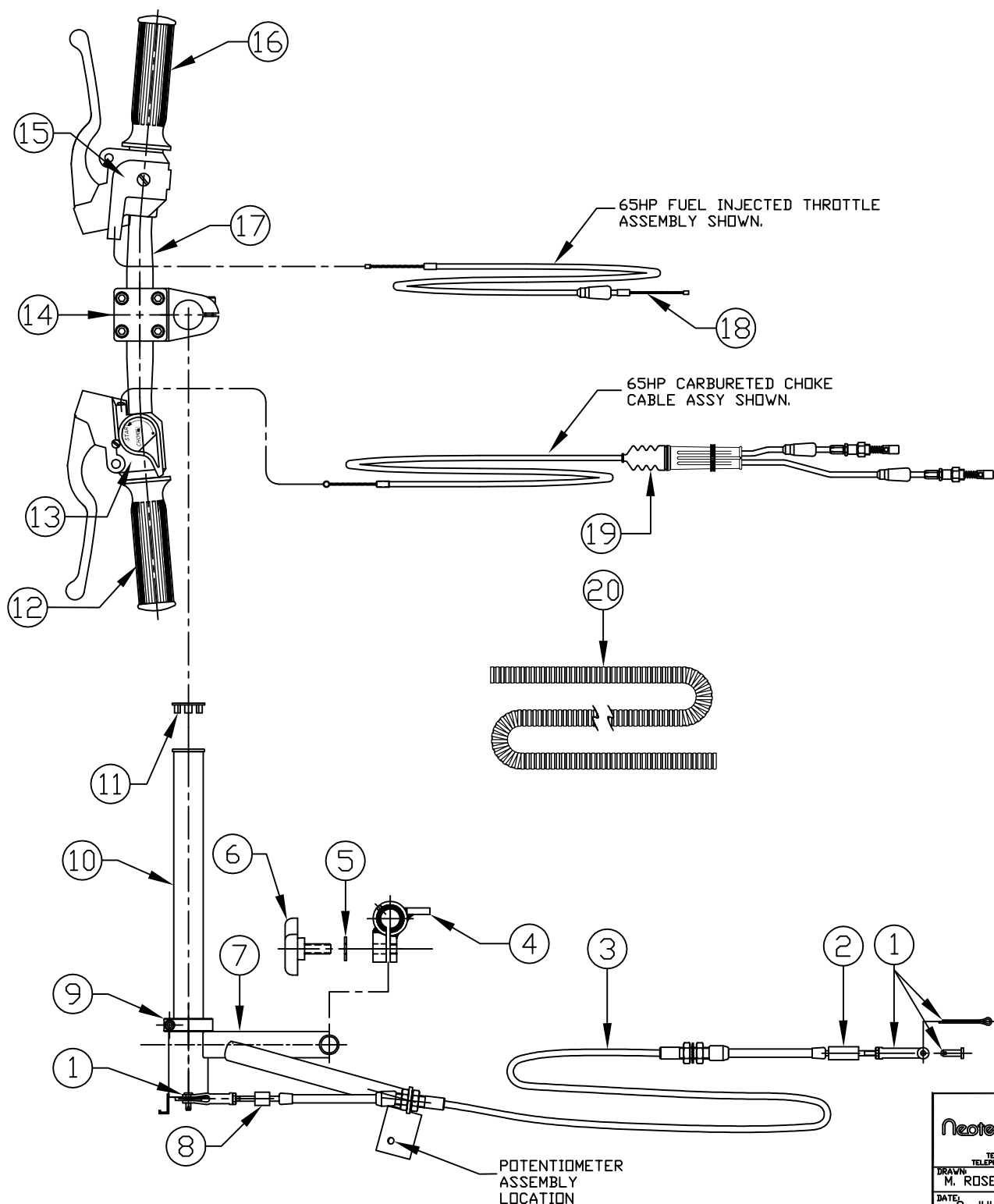

Neoteric Hovercraft Inc.
 1649 TIPPECANOE STREET
 TERRE HAUTE, INDIANA, U.S.A. 47807-8394
 TELEPHONE: (812) 834-1180 FAX: (812) 834-0217

DRAWN: M. ROSEBRAUGH NAME: SIDE BY SIDE SEAT CONTROLS
 DATE: 8 JULY, 2009 FORM: 17110